



HD CAMERA

CS-85XXMT



- HD
- WDR color CMOS
- Automatic shutter open(close) while moving reverse(forward)
- Die-casting housing
- Waterproof (IP67)
- 6 pcs of IR LEDs for night
- Photo sensor

IR LEDs for night



AUTO SHUTTER



WDR Infrared rearview camera has wide visual field and prevent accident in the rear of vehicle by realtime clean image even night.



MODEL NAME & VIEW ANGLE



DIMENSIONS & CABLE

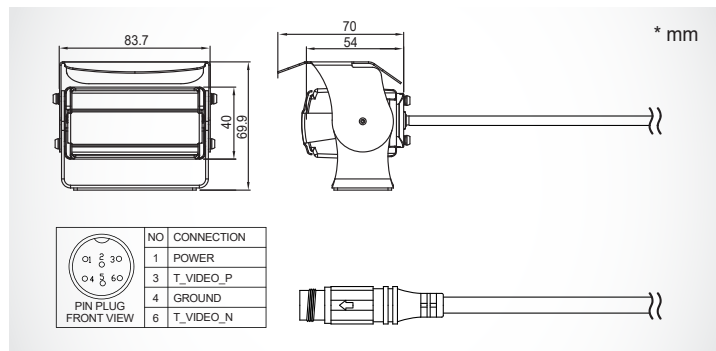

SPECIFICATION

DEVICE	IMAGE DEVICE	1.3M WDR SENSOR 1/3"	
	IMAGE PIXEL SIZE	3.75 μ m (H) x 3.75 μ m (V)	
	RECORDING PIXEL	1,280(H) x 720(V) 1.2MPixel	
	SIGNAL FORMAT	HD	
	ASPECT RATIO	16:9	
	FRAME RATE	30fps	
	SCAN MODE	Progressive	
	TV SYSTEM	NTSC TV SYSTEM	
	IMAGE FREQUENCY	HORIZONTALITY	15.734KHz
		VERTICAL	59.94Hz
	VIDEO OUT	HD video-out	
	HORIZONTAL RESOLUTION	1000 TV Lines	
	S/N RATIO	More Than 50dB (AGC OFF)	
	WHITE BALANCE	Auto	
	OUTPUT	VIDEO PORTS	Exclusive 6 pin connector
		VIDEO TYPE	MIRROR OR NORMAL
	MIC	X	
	IR LED / PHOTO SENSOR	IR 6ea / Photo sensor 1ea / 940nm (White)	
	VIEW ANGLE	CS-8512MT 125(H) / 68(V) / 142(D)	
	MIN. ILLUMINATION	IR ON 0 Lux	
INPUT VOLTAGE	DC 12-24V (MAX 30V)		
OPERATING TEMPERATURE	-20 $^{\circ}$ C ~ 70 $^{\circ}$ C		
STORAGE TEMPERATURE	-30 $^{\circ}$ C ~ 80 $^{\circ}$ C		
WATERPROOF	IP67		
DIMENSION	78(W) x 40(H) x 54(D)mm (w/o Bracket)		
WEIGHT	282g (w/o Bracket)		
CABLE LENGTH	1.0m		
BOX CONTENTS	BRACKET · SUNVISOR	O	
	SCREWS SET	O	
	EXTENSION CABLE	Option	
	MANUAL	O	

AUTO SHUTTER CAMERA

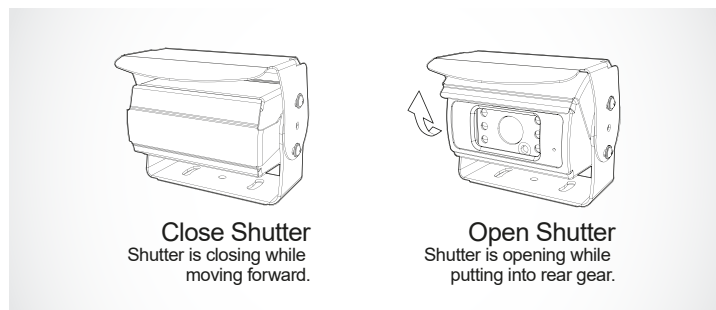

CABLE CONNECTION

