

520,000 PIXEL EYEBALL DOME CAMERA

CS-1509D

- 1/3" (520,000Pixel) 960H color CMOS
- DC 12V~24V
- Die-casting housing
- Waterproof (IP68)
- 9 pcs of IR LEDs for night
- Audio Built-in
- Heating function Built-in
- Photo sensor



SPECIFICATION

VIEW ANGLE	90(H) / 65(V) / 120(D)		
PICK-UP DEVICE	1/3" 960H color CMOS	OPERATING TEMP.	-20°C ~ 70°C
MIN. ILLUMINATION	1.0 lux (F=2.0)	DIMENSION (W/H/D)	84(Dia) x 56.5(H) mm (with bracket)
RESOLUTION	700 TV Lines	WEIGHT	159g (with bracket)
INPUT VOLTAGE	DC 12V - 24V		

DIMENSIONS & CABLE

* mm

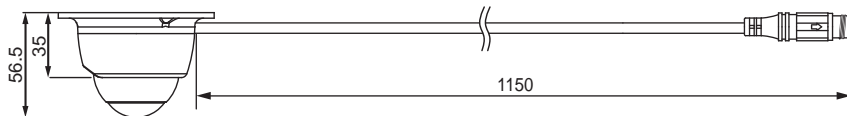
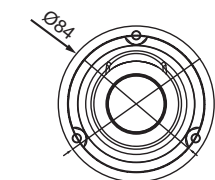

NO	CONNECTION
1	POWER DC
2	AUDIO INPUT
3	VIDEO INPUT
4	HEATING B+
5	S/BY
6	VIDEO GND

PIN PLUG FRONT VIEW

CONNECTION

